

**GROUP B: Plant Maintenance and G&W Offices
Floor Plan**

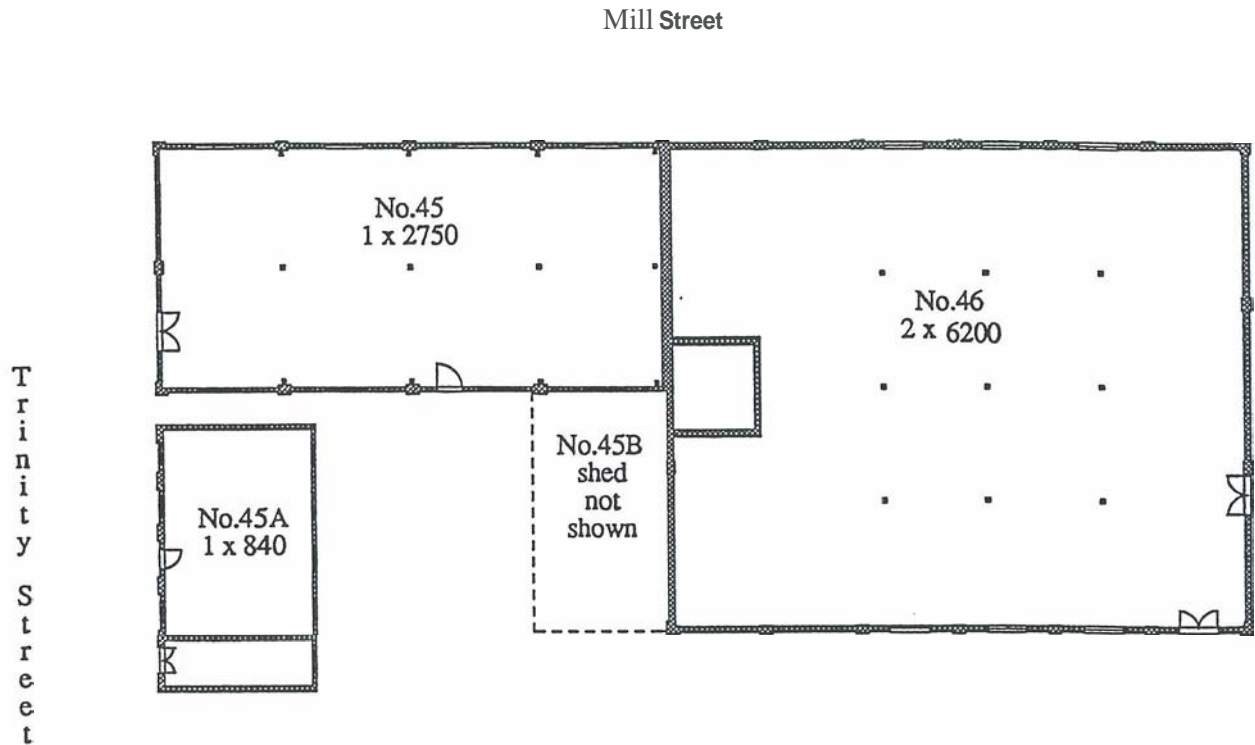

EQUIPMENT SUMMARY

BUILDING #45
Floor 1
45-1-1 Bung Floggers
45-1-2/3 Barrel Brands

BUILDING #46
46-1-1 Platform Scale
46-1-2 Office Safe

BUILDING #45A
No Equipment Observed

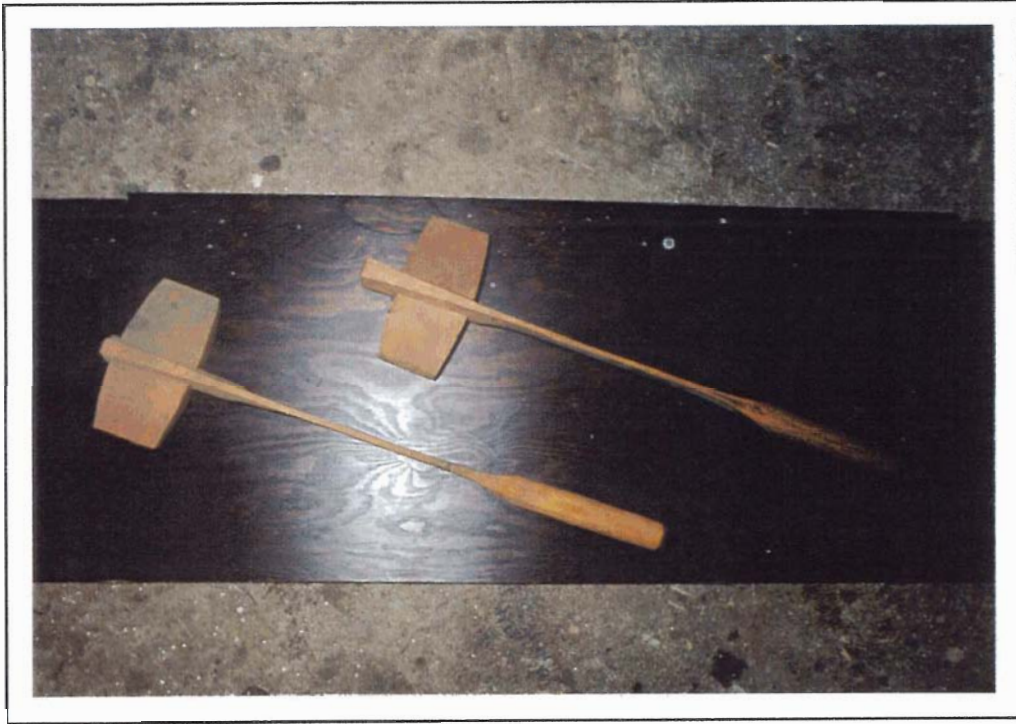

45-1-1 Bung Floggers



45-1-2/3 Barrel Brands

			ITEM NO. 45-1-1
LOCATION	Building #45 Workshop	Floor: 1	Compass: NE
ITEM NAME	Bung Floggers	Quantity	Ca. 12
MARKINGS	None Observed		
MATERIALS	Primary: Wood		
	Secondary:		
DIMENSIONS	Height: 6"	Width: 24"L	Depth:
CONDITION	Unused		
USAGE	A. Distillery: Bung floggers were used by the cellarman in the rack warehouses to loosen barrel bungs to permit sampling.		
	B. General:		
SIGNIFICANCE	Central to distillery maturing operations.		

			ITEM NO. 45-1-2/3
LOCATION	Building #45 Workshop	Floor: 1	Compass: E
ITEM NAME	Barrel Brands C1880-90	Quantity:	2
MARKINGS	Cast "G & W", "GOODERHAM"		
MATERIALS	Primary: Cast steel		
	Secondary:		
DIMENSIONS	Height: 3-8"	Width: 3-4'L	Depth:
CONDITION	Serviceable		
USAGE	A. Distillery: Brands, when heated, were used to impress information into barrel heads, in this case the company name.		
	B. General:		
SIGNIFICANCE	Central to distillery maturing operation.		



46-1-1 Platform Scale



46-1-2 Office Safe

				ITEM NO. 46-1-1
LOCATION	Building #46 Storage	Floor: 1	Compass: SW	
ITEM NAME	Platform Scale C1900	Quantity: 1		
MARKINGS	"FAIRBANKS STANDARD" "NO. 9 MADE IN CANADA" "07"			
MATERIALS	Primary: Wood frame and post Secondary: Cast iron spoke wheels and platform frame Brass balance beam			
DIMENSIONS	Height: 4'	Width: 3'	Depth: 2'	
CONDITION	Serviceable			
USAGE	A. Distillery: To weigh barrels for excise purposes. B. General:			
SIGNIFICANCE	Weighing for excise purposes is central to distillery maturing operations.			

				ITEM NO. 46-1-2
LOCATION	Building #46 Storage	Floor: 1	Compass E	
ITEM NAME	Office Safe C1875	Quantity: 1		
MARKINGS	Stencilled "J & J TAYLOR" "TORONTO SAFE WORKS" "FEB 4TH 75 & AUG 25TH 75" and foliate and geometric decorative paint			
MATERIALS	Primary: Cast and machined steel Secondary: Plated handles and dials			
DIMENSIONS	Height: 6'	Width: 4'	Depth: 4'	
CONDITION	Serviceable			
USAGE	A. Distillery: B. General: Secure storage of monies and documents.			
SIGNIFICANCE	Indicative of early period office practice.			